

# Differential Mode EMI Data Line Filter (TIB2 Series)

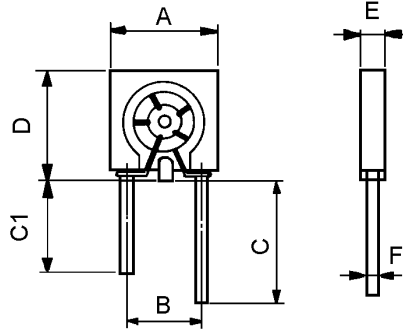

Unit : mm

A :	7.0 +- 0.5
B :	5.0 +- 0.5
C :	19.5 +- 1.0
C1 :	15.5 +- 1.0
D :	8.5 +- 0.5
E :	2.5 +- 0.5
F :	0.6 +- 0.05

**RoHS 2.0**  
2011/65/EU

## Description :

TIB2 Series is a differential mode EMI data line filter, a ferrite core wound by copper wire and fixed on a dip type bobbin. It's often used for signal filter to suppress noise at communication equipments because it's high impedance.

Part Number	Typical Impedance (ohm)		Rated Current (mA MAX)	DC Resistance (m-ohm MAX)	Operating Temperature (°C)
	25MHz	100MHz			
B2-TIB2-24	2350	950	500	120	-25 ~ +85

